



C&N INDUSTRIAL GROUP LIMITED

ASME-B16.9-cap-seamless

ASME-B16.9-Tap ó n-Capa--Conexiones



BETTER PIPELINE BETTER CONNECTION

• Steel pipe • Pipe fitting • Flange

2012-2013

www.cnpipefitting.com
www.steelpipe.me

END CAPS

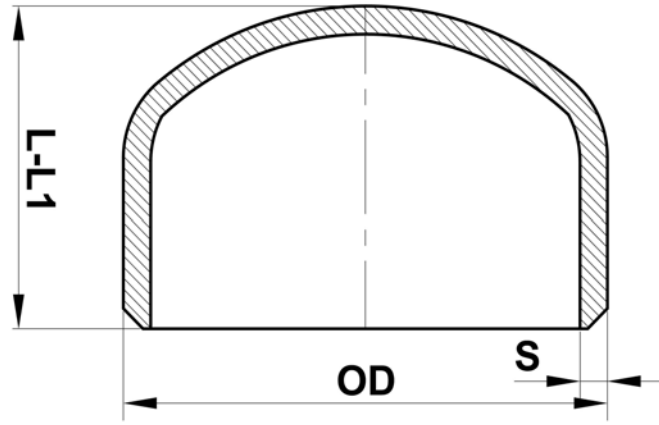

NPS	OD	L	L1	Wall Thickness		Weights(kg)	
				SCH STD	SCH XS	SCH STD	SCH XS
				S	S		
1/2"	21.34	25.90	25.90	2.77	3.73		
3/4"	26.67	31.70	31.70	2.87	3.91		
1"	33.40	38.10	38.10	3.38	4.55	0.10	0.13
1 1/4"	42.16	38.10	38.10	3.56	4.85	0.14	0.19
1 1/2"	48.26	38.10	38.10	3.68	5.08	0.20	0.23
2"	60.32	38.10	44.40	3.91	5.54	0.25	0.30
2 1/2"	73.02	38.10	50.80	5.16	7.01	0.35	0.45
3"	88.90	50.80	63.50	5.49	7.62	0.70	0.85
3 1/2"	101.60	63.50	76.20	5.74	8.08	1.00	1.30
4"	114.30	63.50	76.20	6.02	8.56	1.10	1.60
5"	141.30	76.20	88.90	6.55	9.53	2.00	2.70
6"	168.28	88.90	101.60	7.11	10.97	3.00	4.40
8"	219.08	101.60	127.00	8.18	12.70	5.50	6.35
10"	273.05	127.00	152.40	9.27	12.70	9.00	13.60
12"	323.85	152.40	177.80	9.52	12.70	15.00	22.50
14"	355.60	165.10	190.50	9.52	12.70	16.00	27.00
16"	406.40	177.80	203.20	9.52	12.70	21.00	31.50
18"	457.20	203.20	228.60	9.52	12.70	26.00	36.00
20"	508.00	228.60	254.00	9.52	12.70	32.00	42.00
22"	558.80	254.00	279.40	9.52	12.70	39.00	51.00
24"	609.60	266.70	304.80	9.52	12.70	46.00	60.00
26"	660.40	266.70	266.70	9.52	12.70	49.80	66.10
28"	711.20	266.70	266.70	9.52	12.70	56.00	74.81
30"	762.00	266.70	266.70	9.52	12.70	62.00	82.80
32"	812.00	266.70	266.70	9.52	12.70	68.00	93.40
34"	863.60	266.70	266.70	9.52	12.70	72.60	96.91
36"	914.40	266.70	266.70	9.52	12.70	79.40	107.00
38"	965.20			9.52	12.70	86.20	124.70
40"	1016.00			9.52	12.70	95.30	129.30
42"	1066.80			9.52	12.70	104.00	136.00
44"	1117.60			9.52	12.70	120.20	167.80
46"	1168.40			9.52	12.70	136.00	186.00
48"	1219.20			9.52	12.70	159.00	215.50

L for thicknesses up to XS.

L1 for thicknesses over XS.